

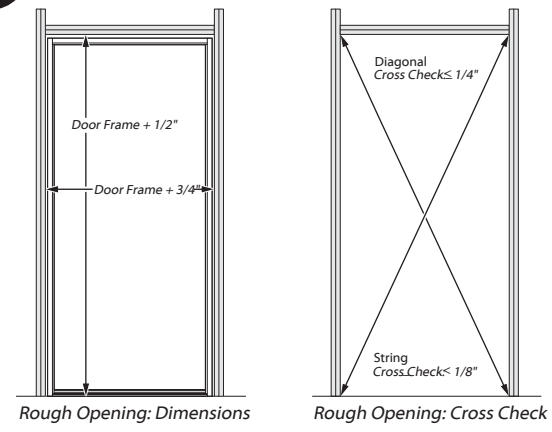

1 Preparing the Rough Opening



Rough Opening Dimensions: Height = Door Frame + 1/2"
Width = Door Frame + 3/4"

Diagonal Distances should be within 1/4" of each other.
Diagonally placed strings should be within 1/8" of each other at the centre.

Ensure support underneath sill front edge overhang. If sill front edge is not properly supported, build out structure to support it.

The rough opening should be flashed according to local building code requirements.

- Are the walls straight?
- Is the rough opening framing plumb & level?
- Is the subfloor clean, dry, level and solid?

If you are using a height plate to bring the sill up to the level of the finished floor covering:

Be sure it that is at least as wide as the sill and as long as the rough opening.

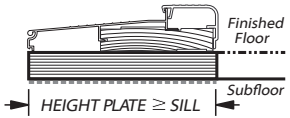

Be sure to caulk thoroughly under and around the height plate.

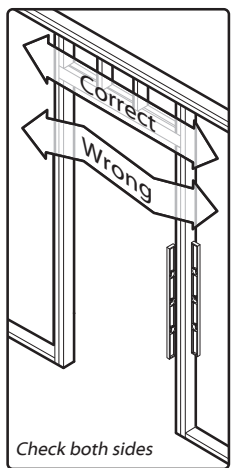

Check both sides



2 Caulking the Rough Opening

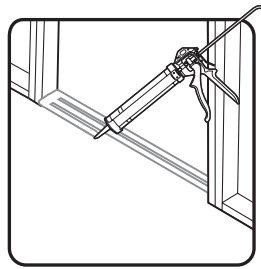

Put three heavy beads (1/2" wide) of polyurethane or 100% silicone sealant or polymer on the subfloor or height plate as shown.

Put enough caulk at the ends to completely cover the bottom of the side jamb.

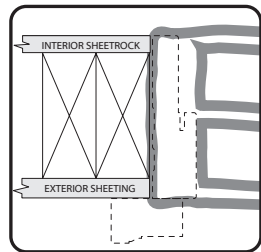

Apply 1/2" bead of polyurethane or 100% silicone or polymer sealant to sheathing side of brickmould or exterior trim (ensure that sealant is compatible with sheathing, housewrap or flashing at rough opening).

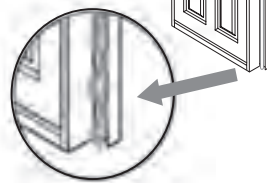

2a Door Top Seal Installation (Outswing Doors Only)

Measure Top of Door Panel



Cut to Length

Mark Door Top Seal the same width as the top of the door.

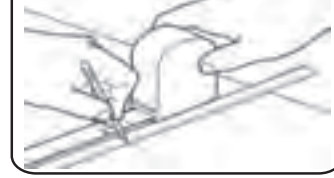

Cut the Door Top Seal at the location of mark.



Size for Double Door Passive Door

Double Doors only. The Door Top Seal must be cut 3/8" shorter than the passive door width to all for the astragal.

Align Door Top Seal on Door

Place end of Door Top Seal flush to edge of hinge stile along outside of edge of door.

Assure that rigid lip of Door Top Seal is against the exterior face of door.

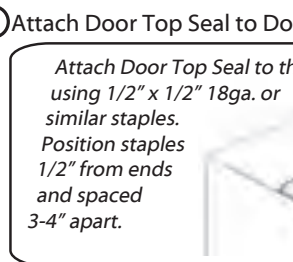

Attach Door Top Seal to Door

Attach Door Top Seal to the top rail using 1/2" x 1/2" 18ga. or similar staples. Position staples 1/2" from ends and spaced 3-4" apart.

Assure that staples are placed under flexible fin and do not staple fin down.



3 Position Unit in Rough Opening

Pivot into position taking care not to wipe away subfloor caulking.

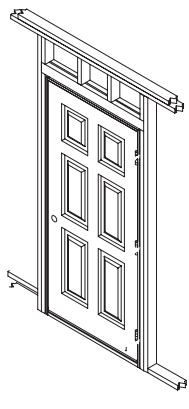

Ensure that unit is plumb in each direction.

Ensure that inside edge of door unit projects 1/2" past stud interior surface for proper alignment with drywall.

Place fasteners through thick part of jambs as shown, just above the hinge positions on the hinge jamb. Do not fully seat. Use 3 screws for 7/0 & shorter units, & 4 screws for 7/5 & taller units.

*For RocSolid installation of Doors with Sidelites, please refer to speciality notes for installation on back of page.

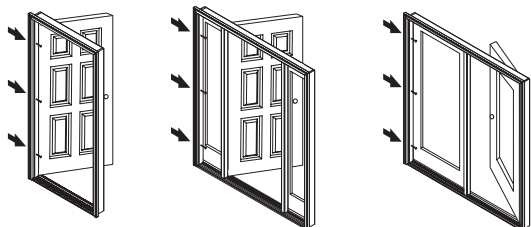

Single Units: Fasten Hinge Jamb first

Sidelite Units: Fasten Sidelite Jamb on Hinge Side first

French & Patio Units: Fasten Jamb on fixed or passive side panel first

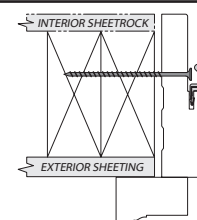

Use #8 x 2-1/2" wood screw or equivalent fastener. Do not fully seat.

Note: Door units installed in high velocity wind zones will require anchoring according to approved requirements.

4 Shim and Secure Hinge Jamb

Check hinge jamb for plumb in both directions with a 6-foot level.

Place shims behind jamb hinges. Adjust shims to take up space between jamb and rough opening. Note: In some cases, the rough opening is plumb and allows the door jamb to be placed against the rough opening. Shims on this side will not be required.

IMPORTANT: Ensure there are adequate shims when installing direct-set door systems. This will prevent any future bowing.

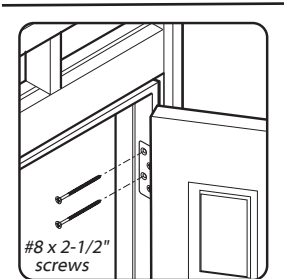

On top hinge, replace 2 short screws closest to weatherstrip with 8 x 2-1/2" screws.

On all other hinges, replace screw closest to weatherstrip.

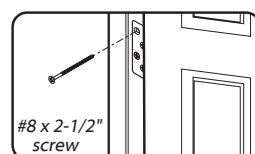

Set each jamb screw through shims, then remove excess shim.

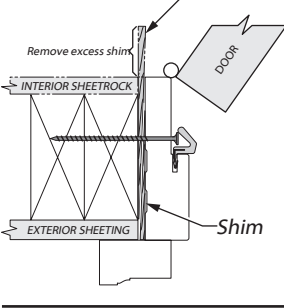

Use 6 foot level to assure that Jamb is not bowed.

If jamb is bowed, adjust positions of shims or add extra shims to correct bow.

Note: Make sure the jamb is not bowed. Adjust or apply additional shims as necessary.

5 Shim and Secure Opposite Jamb

Check jamb for plumb in both directions with a six foot or longer level.

Install shims across from each hinge and adjust to ensure a 1/8" consistent margin between door panel and jamb.

Adjust the frame so it is flush with the face of the door.

Check the weatherstrip contact for even compression all around the door.

Set each jamb fastener through shims.

Remove excess shims when done.

Note: Make sure the jamb is not bowed. Adjust or apply additional shims as necessary.

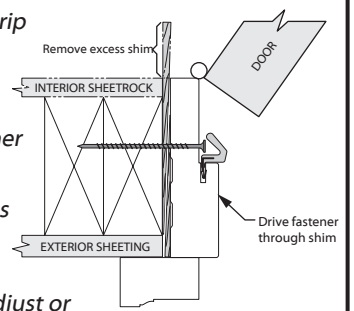
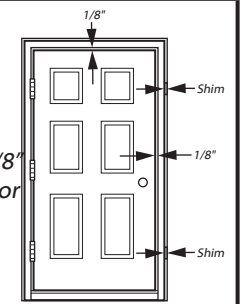

6 Securing Lockset Hardware

Install lockset hardware.

With door closed, shim behind strike and deadbolt plates to maintain proper margin.

Secure each plate with two #8 x 2-1/2" screws through the shim and into the rough stud. Remove excess shim.

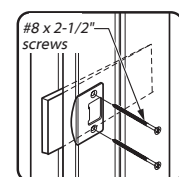
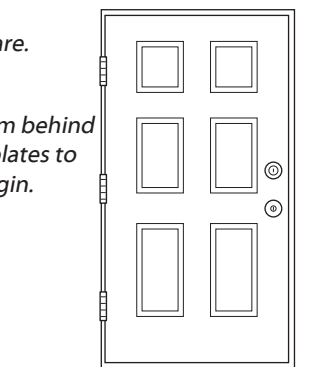

RocSolid Speciality Notes for Installation Pt.1

Trimming Brickmould.

Brickmould is scored on the legs to allow for easy trimming. 1-5/8" brickmould has 1/4" & 1/2" score lines allowing for a 1" reduction in width, and 1/2" in height. The 2" has 3 score lines allowing for up to 1-5/8" reduction in width and a 13/16" reduction in height. NOTE: The back wall is scored and snapped off first to expose the scoring lines on the back of the front wall.



Step 1.
Using a heavy duty utility knife, score down the back of the brickmould on the desired score line.

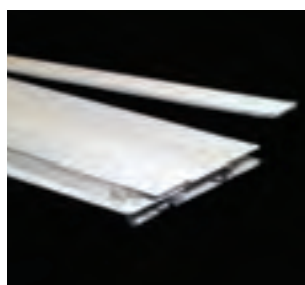

Step 2.
Snap off excess of back leg.



Step 3.
Repeat scoring on the front leg.



Step 4.
Snap off excess of front leg.

Brickmould -Cross Sections

1-5/8" Brickmould

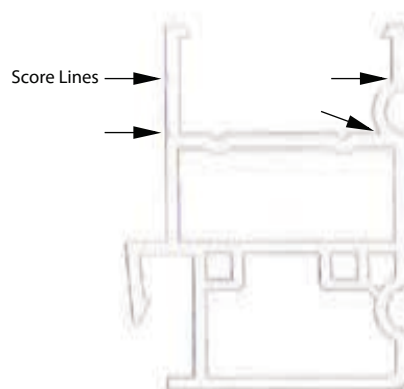

2" Brickmould

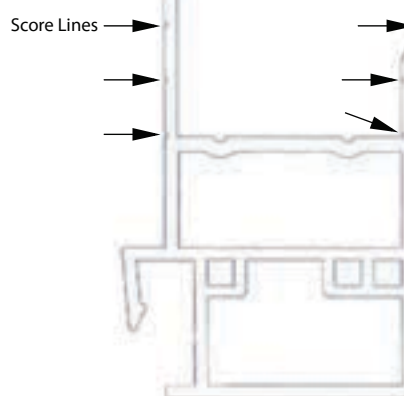

RocSolid Speciality Notes for Installation Pt.2

Fixed Panel Perimeter Installation

When the wood edge is unavailable to use for installation, this process explains the installation through the outer frame and finishing.



Step 1.
Pre-drill all holes for screws from the outside of the jambs using a 1/8" diameter drill bit. Drill through the walls of the jamb (outside to inside).

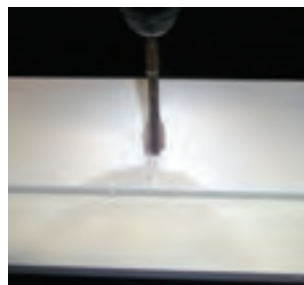

Step 2. (suggested)
On the inside (exposed surface) of the jambs drill a 3/8" diameter hole only through the first wall no more than 1/4" deep using the 1/8" diameter holes from Step 1 as a centre guide.



Step 3.
Drive in installation screws from the inside. The screw head should pass through the larger hole on the inside wall and rest at the smaller hole in the centre wall.



Step 4.
Apply the finishing caps to conceal all holes.

7 Shim and Secure Header

Secure fasteners through thick part of header. Use shims at each location indicated by (X) to maintain proper margin.

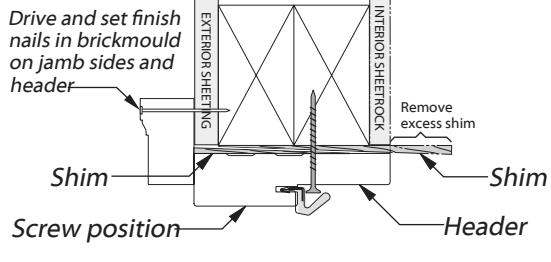
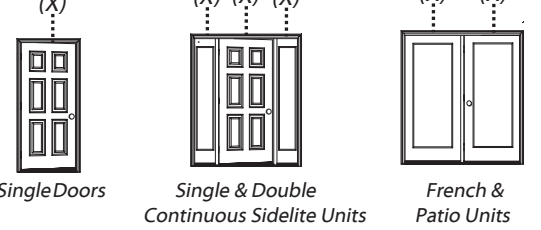

Note: Make sure the jamb is not bowed. Adjust or apply additional shims as necessary.

8a Adjust Sill Cap - Adjustable Sills Only

If necessary, adjust the sill cap to ensure consistent spacing between panel and cap.
*Does not apply to Z Articulating Cap

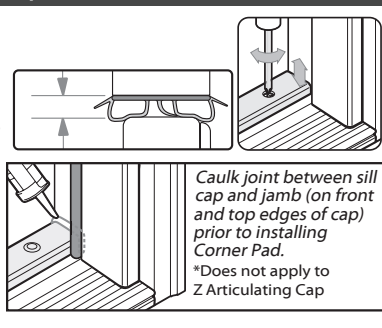

8b Positioning

To install Simple Solution Corner Pads, remove paper backing to expose adhesive and tip pad into place. The edge of the Corner Pad should be flush with the interior side of the jamb. Pads not required on outswing jambs.



On Adjustable Sills/Oak Anchored Caps Corner Pad must be contact the top of the sill cap.



For Z-Articulating Caps, the Simple Solution Corner Pad must contact the top surface for the Z-End Base.



Verify proper installation of Simple Solution Corner Pads.

9 Astragal Positioning (French Units Only)

- Close the passive door to verify that it is in the desired position.
- Push bolt pins to contact header and sill, then mark positions for retainer holes.
- Complete installation and positioning of astragal according to Endura's "Field Installation Instructions" provided with the French unit.
- The strikes should be adjusted in the direction of door closure to assure that the strikes pull the door up to the weatherstrip tightly.
- Use Strike provided with handleset (sold separately). Standard deadbolt location is up to 5-1/2 centre to centre of Strike and deadbolt.

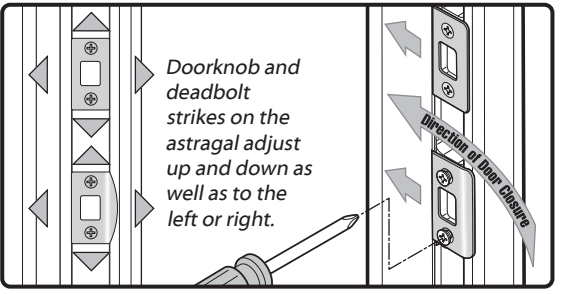

10 Caulking Sill

Use polyurethane or 100% silicone or polymer sealant in the areas indicated.

- Caulk the intersection of the aluminum sill deck and the jamb.
- Seal front bottom edge of sill.
- Caulk around the intersection of the mull and the door sill.
- If a sill extender is installed, apply a bead of caulk where the extender meets the sill deck.

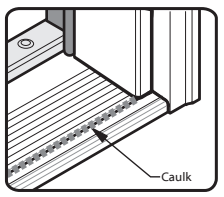
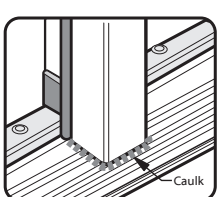
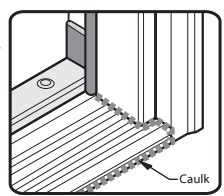

11 Weatherproofing

- Caulk around the entire unit on weather-exposed side between brickmould and siding or sheathing.
- Caulk at joint of brickmould and jamb
Caulk at joint of header and side of jamb
Caulk around perimeter of sidelite panel and jamb
- Install flashing above protruding header trim in shingle lap fashion, or per manufacturer's instructions.
- Insulate the gap between the frame and rough opening according to local code requirements or building practices.

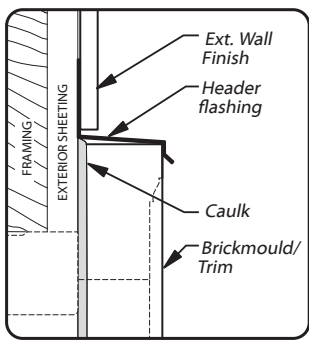
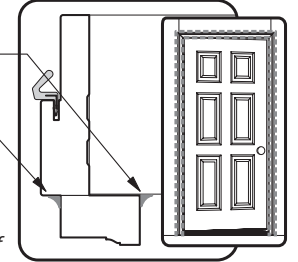

Installation Checklist

- Clean, dry, level, and solid subfloor (1)
- Three beads of caulk under the Sill (2)
- Ensure consistent margins (5)
- Adjust the Sill Cap or Door Bottom (8)
- Install Simple Solution® Corner Pads (8)
- Position & Install Astragal (French Units) (9)
- Caulk as specified above (10)
- Weatherproof door unit and use flashing (11)

Disclaimer: Warranty is void if installation instructions are not followed. Warranty includes replacement components on systems. Labour is not included.

Visit www.doorsmith.ca for warranty details.

Installation Video



Note: This instruction assumes that an appropriate weather-resistive barrier, as required by local building codes, is installed per manufacturer's instructions around the rough opening prior to door installation.

Note: This instruction applies to both inswing and outswing doors, except where noted.

Note: This instruction applies to both adjustable and fixed sills, except where noted. 03/14

